



KT-WPLED80-M1-8CSB-VDIM

TRADITIONAL 80W NON-CUTOFF LED WALL PACK

DESCRIPTION

Traditional 80W Non-Cutoff LED Wall Pack | 120–277V Input | 3000–5000K | Medium-Size Bronze Housing | Glass Lens

APPLICATION

Building Mount for exterior illumination (perimeters, pathways, loading docks, and other general security lighting requirements)



PRODUCT FEATURES

- Traditional design matches appearance and light distribution pattern of legacy HID, optimized for one-for-one replacements
- Heavy-duty, die-cast aluminum housing with (5) available 1/2" threaded conduit hubs: (1) on back and (1) on all four sides
- Powered by Keystone 0–10V dimming LED drivers
- Keystone Color Select Technology: Adjustable CCT (3000K, 4000K, or 5000K)
- Built-in dusk-to-dawn photocell behind translucent 3/4" threaded plug with anti-yellowing agent
- Borosilicate glass lens diffuses light source and provides uniform distribution
- Covers footprint of mid-size HID wallpacks
- Ambient operating temperature: –40°C/–40°F to 50°C/122°F
- UL listed for wet locations, IP65
- 0–10V dimming, 10% min
- Power Factor: >0.95
- THD: <20%
- LED chip lifetime: L70 >100,000 hrs @ 25°C/77°F ambient fixture temp
- Meets FCC Part 15, Part B, Class A standards for conducted and radiated emissions
- Fixture impact rating IK06
- Compatible with Keystone LED Emergency Backups

ELECTRICAL SPECIFICATIONS

| Catalog Number | Wattage | Lumens | Lumens Below 90° | Dimming | CCT* | Efficacy | CRI | Housing Color | Input Voltage | Rated Life | Legacy Equivalent |
|-------------------------|---------|----------|------------------|---------|-------|----------|-----|---------------|---------------|------------|-------------------|
| KT-WPLED80-M1-8CSB-VDIM | 80W | 10955 lm | 9860 lm | 0–10V | 3000K | 137 lm/W | >80 | Bronze | 120–277V | 50,000 hrs | 250–320W MH |
| | | 11925 lm | 10730 lm | | 4000K | 149 lm/W | | | | | |
| | | 11360 lm | 10225 lm | | 5000K | 142 lm/W | | | | | |

* Color Uniformity: CCT (Correlated Color Temperature) range as per guidelines outlined in ANSI C78.377-2017



KT-WPLED80-M1-8CSB-VDIM

TRADITIONAL 80W NON-CUTOFF LED WALL PACK

PHOTOMETRIC SPECIFICATIONS

ISOCANDELA PLOT

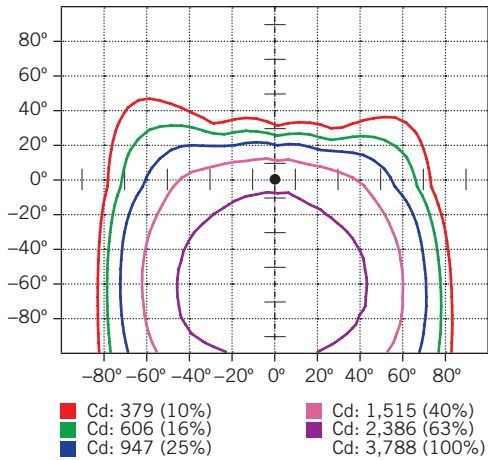

LUMINOUS INTENSITY DISTRIBUTION

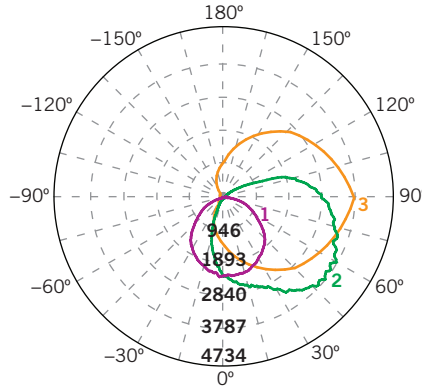

Average diffuse angle (50%): **111.4°**

- 1 Violet C0-C180
- 2 Green C90-C270
- 3 Orange G51

Unit: cd

FLUX DISTRIBUTION

| Zone | Lumens | % Luminaire |
|----------------------|----------|-------------|
| Forward Light | 8,671 lm | 79.6% |
| 0°-30° | 1,281 lm | 11.8% |
| 30°-60° | 3,696 lm | 33.9% |
| 60°-80° | 2,660 lm | 24.4% |
| 80°-90° | 1,035 lm | 9.5% |
| Back Light | 1,029 lm | 9.5% |
| 0°-30° | 409 lm | 3.8% |
| 30°-60° | 471 lm | 4.3% |
| 60°-80° | 126 lm | 1.2% |
| 80°-90° | 23 lm | 0.2% |
| Up Light | 1,195 lm | 11.0% |
| 90°-100° | 551 lm | 5.1% |
| 100°-180° | 644 lm | 5.9% |

BUG* Rating

| Asymmetrical Luminaire Types | |
|---|----------|
| Type I, II, III, IV | B1 U4 G5 |
| Quadrilateral Symmetrical Luminaire Types | |
| Type V, Area Light | B1 U4 G5 |

* Backlight, Uplight, Glare

MOUNTING

Side view

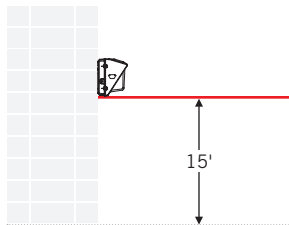

LIGHT DISTRIBUTION PATTERN

Isometric view from above; Luminaire mounted at 15'

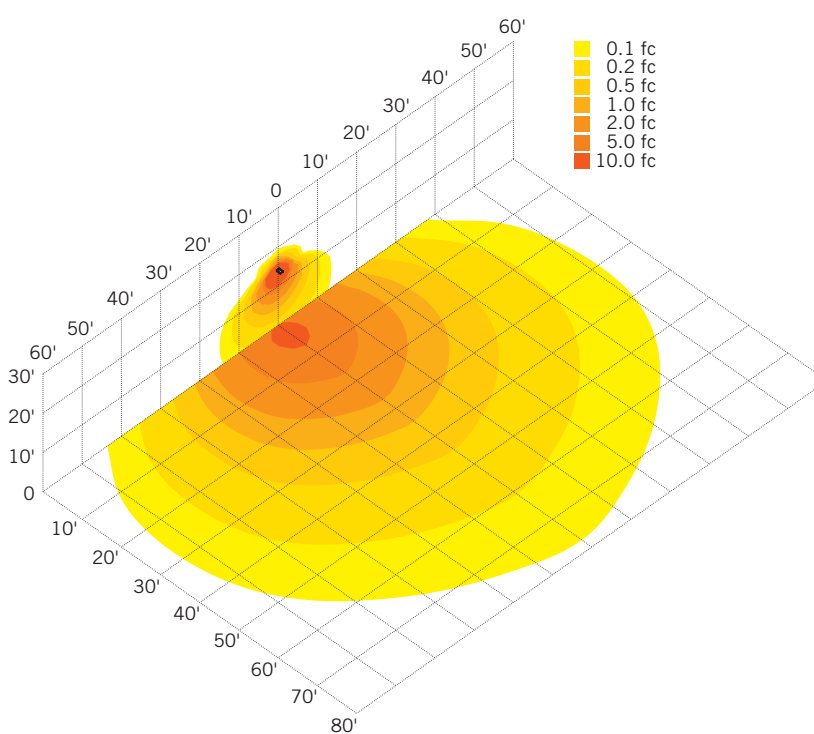



KT-WPLED80-M1-8CSB-VDIM

TRADITIONAL 80W NON-CUTOFF LED WALL PACK

PHYSICAL SPECIFICATIONS

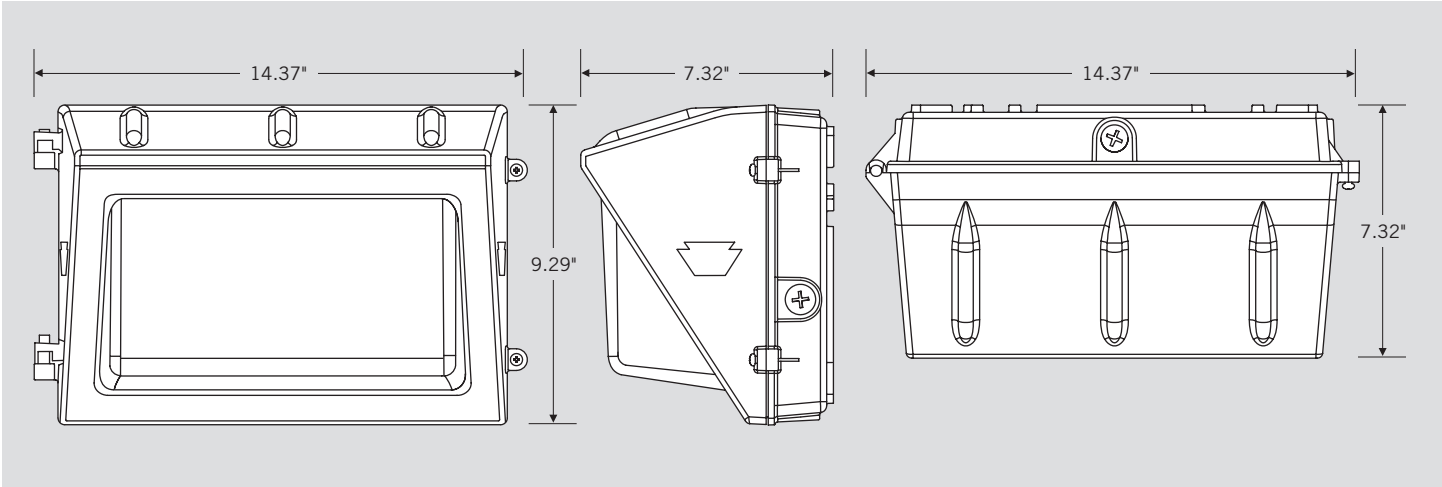

GENERAL SETUP INSTRUCTIONS

GENERAL WIRING DIAGRAM

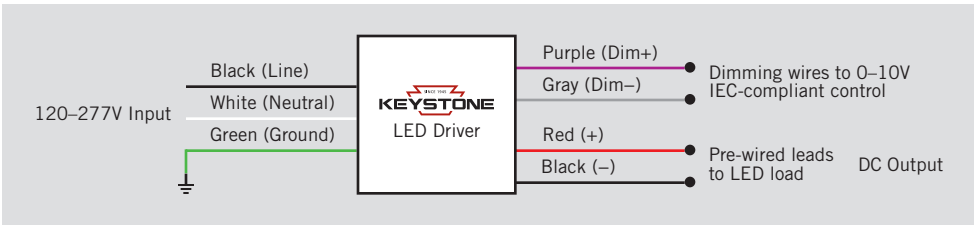

Caution: Before installing, make certain that AC power to the fixture is off.

Caution: The electrical rating of this product is 120-277V. Installer must confirm that there is 120-277V at the fixture before installation.

PHOTOCELL ENABLE/DISABLE

This fixture is equipped with a dusk-to-dawn photocell behind the translucent knock-out (KO) cover. Adjust the dip switch to enable (ON) or disable (OFF) the photocell function (see illustrations to the right). Fixture comes preset with photocell enabled unless otherwise noted.

COLOR SELECT (CCT) ADJUSTMENT

This fixture is equipped with Color Select technology. There is an adjustable dip switch behind the translucent knock-out (KO) cover to change CCT between 5000K, 4000K, and 3000K (see illustrations to the right). Fixture comes preset at 5000K unless otherwise noted.

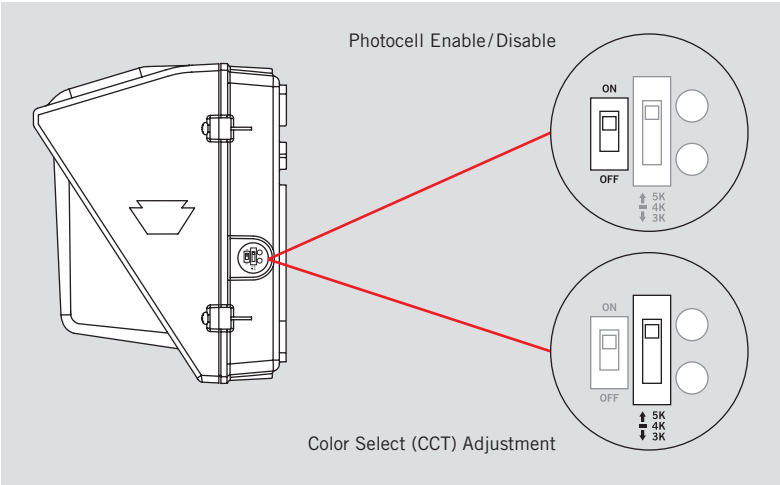



KT-WPLED80-M1-8CSB-VDIM

TRADITIONAL 80W NON-CUTOFF LED WALL PACK

ACCESSORY (SOLD SEPARATELY)

| Catalog Number | Description |
|----------------|---|
| KTSP-10KV-C | Wallpack 10kV Surge Protector, Compact Design |

ORDERING INFORMATION

| CATALOG NUMBER | PACK QTY. | EASY CODE | UPC |
|-------------------------|-----------|-----------|--------------|
| KT-WPLED80-M1-8CSB-VDIM | 1 | XNA-33 | 843654129037 |

CATALOG NUMBER BREAKDOWN

KT-WPLED80-M1-8CSB-VDIM

| | | | | | | | | | | | | | | | | | | | | | | | | | | | | | | | | | | | | | | | | | | | | | | | | | | |
|--------------------------------|--|-------------------|----------------------|---------------|----------------|--------------|----------------|---|-------------------|------------------------------|---|--------|---|-------|---|---|------------|---|-------------|--|---|-----|---|-----|--|----|-------|----|-------|----|--------------|---|---|---------------------|---|---------------------|---|----------------------------|---|-----|---|------|-------|--|--|-----------|-----|--------------------------------------|----------|--|
| 1 | 2 | 3 | 4 | 5 | 6 | 7 | 8 | 9 | 10 | 11 | | | | | | | | | | | | | | | | | | | | | | | | | | | | | | | | | | | | | | | | |
| 1 Keystone Technologies | 2 Fixture Type | 3 LED Lamp | 4 Max Wattage | 5 Size | 6 Style | 7 CRI | 8 Color | 9 Color Select Designation | 10 Dimming | 11 Additional Options | | | | | | | | | | | | | | | | | | | | | | | | | | | | | | | | | | | | | | | | |
| | <table border="1" style="width: 100%;"> <tr><td>F</td><td>Flood</td></tr> <tr><td>WP</td><td>Wallpack</td></tr> </table> | F | Flood | WP | Wallpack | | | <table border="1" style="width: 100%;"> <tr><td>S</td><td>Small</td></tr> <tr><td>M</td><td>Medium</td></tr> <tr><td>L</td><td>Large</td></tr> </table> | S | Small | M | Medium | L | Large | <table border="1" style="width: 100%;"> <tr><td>1</td><td>Non-Cutoff</td></tr> <tr><td>2</td><td>Full-Cutoff</td></tr> </table> | 1 | Non-Cutoff | 2 | Full-Cutoff | <table border="1" style="width: 100%;"> <tr><td>8</td><td>>80</td></tr> <tr><td>9</td><td>>90</td></tr> </table> | 8 | >80 | 9 | >90 | <table border="1" style="width: 100%;"> <tr><td>40</td><td>4000K</td></tr> <tr><td>50</td><td>5000K</td></tr> <tr><td>CS</td><td>Color Select</td></tr> </table> | 40 | 4000K | 50 | 5000K | CS | Color Select | <table border="1" style="width: 100%;"> <tr><td>A</td><td>3500K, 4000K, 5000K</td></tr> <tr><td>B</td><td>3000K, 4000K, 5000K</td></tr> <tr><td>C</td><td>3000K, 3500K, 4000K, 5000K</td></tr> <tr><td>D</td><td>TBD</td></tr> </table> | A | 3500K, 4000K, 5000K | B | 3000K, 4000K, 5000K | C | 3000K, 3500K, 4000K, 5000K | D | TBD | <table border="1" style="width: 100%;"> <tr><td>VDIM</td><td>0-10V</td></tr> </table> | VDIM | 0-10V | <table border="1" style="width: 100%;"> <tr><td></td><td>No option</td></tr> <tr><td>/MW</td><td>Microwave occupancy Sensor Installed</td></tr> <tr><td>/EMRG-12</td><td>12W Emergency Battery Backup Installed</td></tr> </table> | | No option | /MW | Microwave occupancy Sensor Installed | /EMRG-12 | 12W Emergency Battery Backup Installed |
| F | Flood | | | | | | | | | | | | | | | | | | | | | | | | | | | | | | | | | | | | | | | | | | | | | | | | | |
| WP | Wallpack | | | | | | | | | | | | | | | | | | | | | | | | | | | | | | | | | | | | | | | | | | | | | | | | | |
| S | Small | | | | | | | | | | | | | | | | | | | | | | | | | | | | | | | | | | | | | | | | | | | | | | | | | |
| M | Medium | | | | | | | | | | | | | | | | | | | | | | | | | | | | | | | | | | | | | | | | | | | | | | | | | |
| L | Large | | | | | | | | | | | | | | | | | | | | | | | | | | | | | | | | | | | | | | | | | | | | | | | | | |
| 1 | Non-Cutoff | | | | | | | | | | | | | | | | | | | | | | | | | | | | | | | | | | | | | | | | | | | | | | | | | |
| 2 | Full-Cutoff | | | | | | | | | | | | | | | | | | | | | | | | | | | | | | | | | | | | | | | | | | | | | | | | | |
| 8 | >80 | | | | | | | | | | | | | | | | | | | | | | | | | | | | | | | | | | | | | | | | | | | | | | | | | |
| 9 | >90 | | | | | | | | | | | | | | | | | | | | | | | | | | | | | | | | | | | | | | | | | | | | | | | | | |
| 40 | 4000K | | | | | | | | | | | | | | | | | | | | | | | | | | | | | | | | | | | | | | | | | | | | | | | | | |
| 50 | 5000K | | | | | | | | | | | | | | | | | | | | | | | | | | | | | | | | | | | | | | | | | | | | | | | | | |
| CS | Color Select | | | | | | | | | | | | | | | | | | | | | | | | | | | | | | | | | | | | | | | | | | | | | | | | | |
| A | 3500K, 4000K, 5000K | | | | | | | | | | | | | | | | | | | | | | | | | | | | | | | | | | | | | | | | | | | | | | | | | |
| B | 3000K, 4000K, 5000K | | | | | | | | | | | | | | | | | | | | | | | | | | | | | | | | | | | | | | | | | | | | | | | | | |
| C | 3000K, 3500K, 4000K, 5000K | | | | | | | | | | | | | | | | | | | | | | | | | | | | | | | | | | | | | | | | | | | | | | | | | |
| D | TBD | | | | | | | | | | | | | | | | | | | | | | | | | | | | | | | | | | | | | | | | | | | | | | | | | |
| VDIM | 0-10V | | | | | | | | | | | | | | | | | | | | | | | | | | | | | | | | | | | | | | | | | | | | | | | | | |
| | No option | | | | | | | | | | | | | | | | | | | | | | | | | | | | | | | | | | | | | | | | | | | | | | | | | |
| /MW | Microwave occupancy Sensor Installed | | | | | | | | | | | | | | | | | | | | | | | | | | | | | | | | | | | | | | | | | | | | | | | | | |
| /EMRG-12 | 12W Emergency Battery Backup Installed | | | | | | | | | | | | | | | | | | | | | | | | | | | | | | | | | | | | | | | | | | | | | | | | | |